

Sta. to Sta.	Left of C.	Right of C.	Total
1140+00 to 1150+00	40'	40'	80' Existing
1143+00 to 1146+00	70'	70'	140' New
1143+50 to 1145+00	100'	100'	200' Temporary

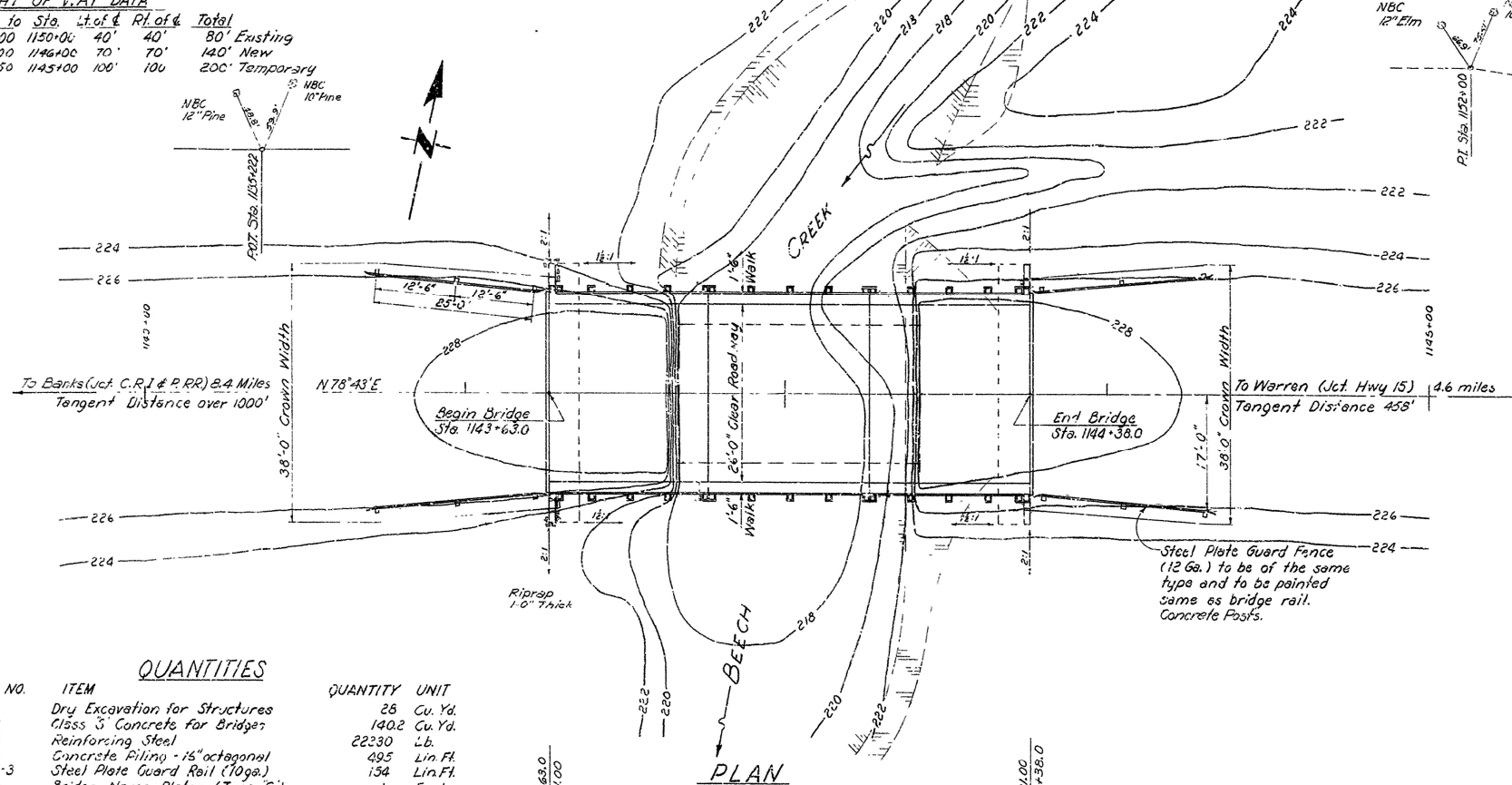

ITEM NO.	ITEM	QUANTITY	UNIT
103	Dry Excavation for Structures	25	Cu. Yd.
SP-802	Class 3 Concrete for Bridges	140.2	Cu. Yd.
SP-803	Reinforcing Steel	22230	Lb.
SP-804	Concrete Piling - 16" octagonal	495	Lin. Ft.
SP-805-3	Steel Plate Guard Rail (Type C)	134	Lin. Ft.
959	Bridge Name Plates (Type C)	1	Each
SP-1052-B	Removal of Existing Bridge Structures and Maintenance of Traffic	5%	Complete Item

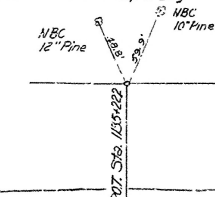
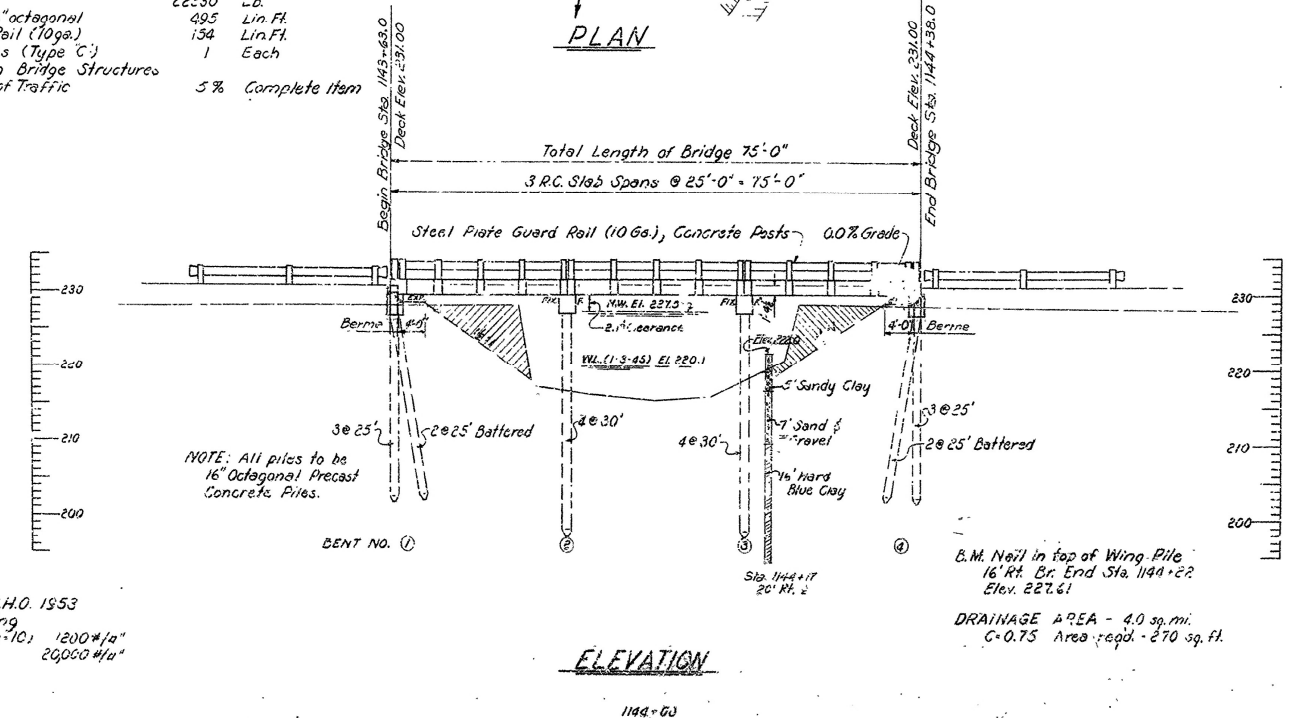

NOTE: The Bridge Contractor under Job No. 7434 shall remove the present Bridge No. 818, consisting of two 19'-0" T.I. Spans.

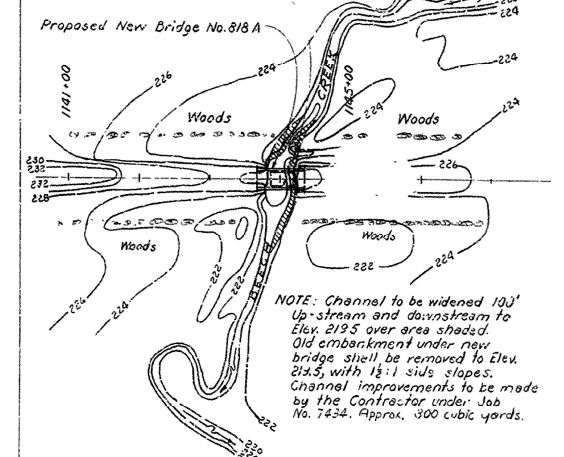

LOCATION SKETCH
SHOWING CHANNEL IMPROVEMENT
Scale: 1"=100'-0"

GENERAL NOTES:

All concrete to be Class "S" and shall be poured in the dry. All exposed corners to be chamfered & unless otherwise noted, Concrete piling to be 16" octagonal precast and shall be driven to a minimum capacity of 35 tons per pile and to a minimum penetration of 20' below natural ground line. Lengths of piling shown are for estimating quantities only. Actual lengths are to be determined in the field. Drive one pile in Bent No. 2 as a test pile. Cast 35' long. Volume occupied by embedded pile heads will not be included in pay quantity of concrete slabs. The present bridge, which consists of two 19'-0" treated timber spans with 19'-0" roadway, treated pile bents with 4' timber bulkheads on end bents, shall be removed by the Bridge Contractor - Job No. 7434. The channel improvement shall be made by the Contractor under Job No. 7434. For Details of Std. Bent, see Dwg. No. 5415. For Details of Std. 25' x 25' R.C. Slab Spans see Dwg. No. 5416. SPECIFICATIONS: Arkansas State Highway Commission Standard Specifications for Road and Bridge Construction adopted March, 1953.

LAYOUT OF
BRIDGE OVER BEECH CREEK
HARRELL-WARREN
BRADLEY COUNTY
ROUTE 4 SEC. 12

ARKANSAS STATE HIGHWAY COMMISSION
LITTLE ROCK, ARK.
Drawn By: J.S. Date: 7-12-53
Typed By: J.S. Date: 7-12-53
Checked By: J.S. Date: 7-12-53
Scale: 1"=10'
BRIDGE NO. 818-A
DRAWING NO. 8450

DESIGN SPECIFICATIONS: A.A.S.H.O. 1953
Design Live Load - H-20 Loading
STRESSES: Class "S" Concrete (7-10) 1200 #/sq.
Reinforcing Steel 20000 #/sq.